

CATTLE TROUGH PLAN

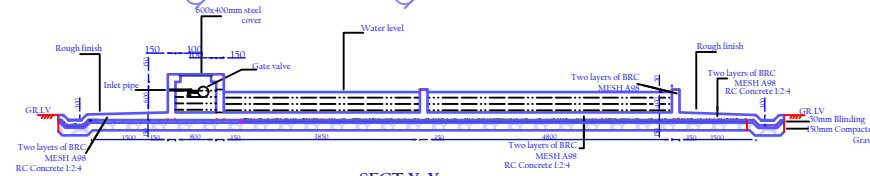

SECT X-X

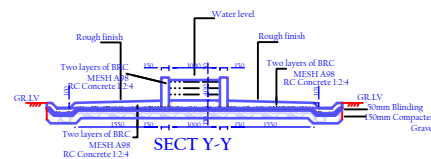

SECT Y-Y

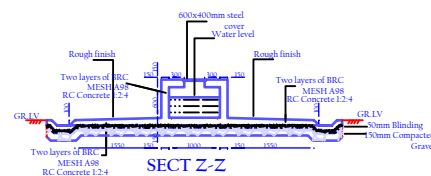

SECT Z-Z

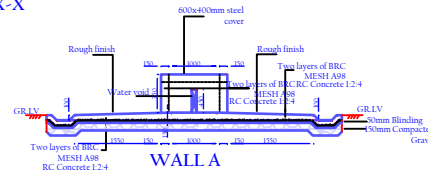

WALL A

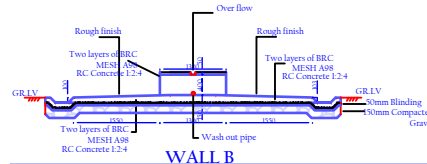

WALL B

- Concrete to have minimum crushing strength of 4.20 N/mm^2 28 days.
- Building stones to be machine cut & to have crushing strength of $4.6.0 \text{ N/mm}^2$.
- Mortar mix to be 1:3.
- a. Y=High yield steel bars to B.S. 4449.
- b. R=Mid yield steel bars to B.S. 4449.
- c. T1=Top 1st layer, T2=Top 2nd layer
- d. B1=Bottom 1st layer, B2=Bottom 2nd layer
- e. D.O.S.=Determine On Site.
- Design Bearing capacity = 250 kN/m^2
- Cover to reinforcement:
Beams = 50mm, Columns = 40mm
Beams = 25mm, Slabs = 15mm.
- Top reinforcing bars in slab & beams to be lapped at mid span while bottom bars at support.

NOTES

1. ALL DIMENSIONS ARE TO BE CONFIRMED ON SITE AND ANY DISCREPANCY REFERRED TO THE ARCHITECT.
2. FV DIRECTED PERMANENTLY AWAY OVER DOORS & WINDOWS AS MARKED ON PLANS & ELEVATIONS.
3. ALL RC WORK TO BE DONE IN ACCORDANCE WITH THE SPECIFICATIONS.
4. ALL SANITARY WORK TO BE IN ACCORDANCE WITH THE SPECIFICATIONS.
5. ALL DRAIN PIPES PASSING UNDER BUILDING OR DRIVEWAY TO BE ENCASED IN 150mm CONCRETE SURROUND.
6. ALL WASTE PIPES & SOIL PIPES TO HAVE AN INSPECTION CHAMBER ACCESSIBLE FROM OUTSIDE.
7. INSPECTION CHAMBERS & DRAINWAYS TO HAVE HEAVY DUTY COVERS.
8. ALL WALLS LESS THAN 200mm THICK TO BE REINFORCED WITH HOOK BARS AT EVERY ALTERNATE COURSE.
9. EPC TO BE OF APPROVED PLASTIC MEMBRANE PROVIDED UNDER ALL WALLS EXCEPT DOORWAYS.
10. ALL ELECTRICAL WORK TO BE CARRIED OUT BY A LICENSED ELECTRICIAN TO THE SATISFACTION OF AREA POWER AND LIGHTING CL.

FINISHES

CLIENT:
PRINCIPAL SECRETARY MINISTRY OF
AGRICULTURE, LIVESTOCK AND FISHERIES
P.O BOX 30028-00100, NAIROBI

PROJECT NAME:
PROPOSED DRILLING/DEVELOPMENT OF KIPKOLONY
COMMUNITY BORE HOLE

ON PLOT LR. NO. ...

PROJECT TITLE:
WATER TROUGH

PLAN SECTION/ELEVATION	COUNTY: SAMBURU
SCALE 1:100 (A3)	DATE August 2022
DRAWN Kirui S. K.	DRAWN 01