

CATTLE TROUGH PLAN

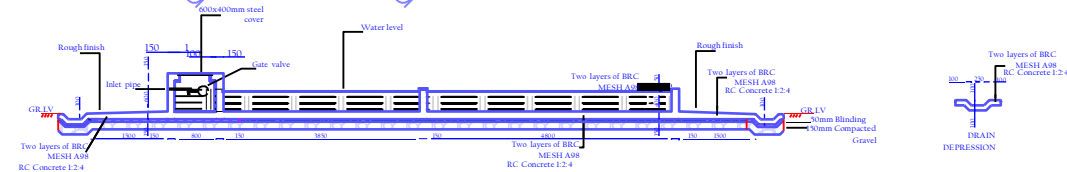

SECT X-X

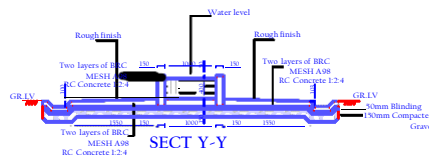

SECT Y-Y

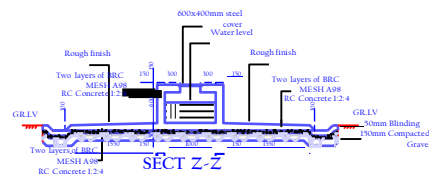

SECT Z-Z

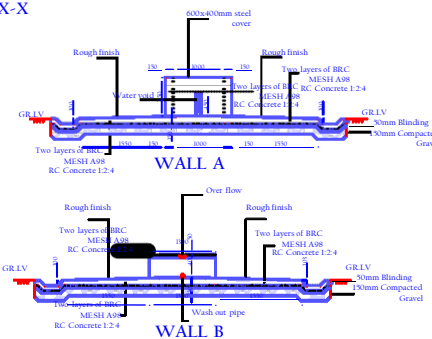

WALL B

- Concrete to have minimum crushing strength of $\geq 20 \text{ N/mm}^2$ at 28 days.
- Building stones to be machine cut & to have crushing strength of $\geq 6.0 \text{ N/mm}^2$.
Mortar mix to be 1:3
- a. Y-High yield steel bars to B.S. 4449.
b. R-Mild yield steel bars to B.S. 4449.
c. T1-Top 1st layer, T2-Top 2nd layer
d. B1-Bottom 1st layer, B2-Bottom 2nd layer
e. D.O.S-Determine On Site.
- Design Bearing capacity = 250 KN/m^2
- Cover to reinforcement:
Bases = 75mm, Column = 40mm
Beams = 25mm, Slabs = 15mm.
- Top reinforcing bars in slab & beams to be lapped at mid-span while bottom bars at support.

NOTES

- ALL DIMENSIONS ARE TO BE CONFIRMED ON SITE AND ANY DISCREPANCY REFERRED TO THE ARCHITECT
- IF FINISHED PERMANENT AIR VENT OVER DOORS & WINDOWS AS MARKED ON PLAN & ELEVATIONS
- ALL RC WORK TO ENGINEER'S DETAIL
- ALL SANITARY WORK TO MAJOR REGULATIONS
- ALL DRAIN PIPES PASSING UNDER BUILDING OR OTHERWISE TO BE ENCASED IN 150mm CONCRETE ENCASEMENT
- ALL WATER PIPES & SOIL PIPES TO HAVE AN INJECTION FOR ACCESSIBLE FROM ANY SIDE
- DIRECTION CHAMBERS IN OTHER WAY TO HAVE HEAVY DUTY COVERS
- ALL WALLS EXCEPT THOSE THICK TO BE DEMONSTRATED WITH DROP BODY AT EVERY ALTERNATE COURSE
- SPC TO BE OF APPROVED PLATE MEMBRANE NOTIFIED UNDER ALL WALL EXCEPT DOORWAYS
- ALL ELECTRICAL WORK TO BE CARRIED OUT BY A LICENSED ELECTRICIAN TO THE SATISFACTION OF KENYA POWER AND LIGHTING CO.

FINISHES

CLIENT:
SAMBURU COUNTY AND USAID Nairobi
P.O. BOX 30028-00100, NAIROBI

PROJECT NAME:
PROPOSED CONSTRUCTION OF LIVESTOCK TROUGH AT
LEWASHI COMMUNITY BOREHOLE

ON PLOT LR. NO.

PROJECT TITLE:
LIVESTOCK WATER TROUGH

PLAN SECTION/ELEVATION	COUNTY: SAMBURU
SCALE 1:100 (A3)	DATE August 2022
DRAWN 01	DRAWN Kirui S. K.